

The Ashford

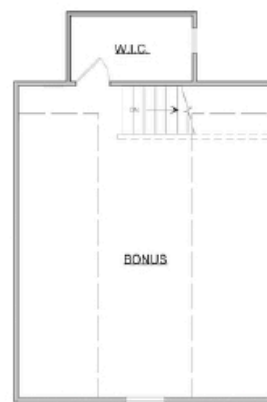

Imperial Series | 2 Car Front Entry Garage | 3 Bedroom | 2 Bathrooms



First Floor:	1,378 sqft
Second Floor:	492 sqft
Garage:	476 sqft
Total Living Area:	1,870 sqft

SMITHBILT HOMES RESERVES THE RIGHT TO MAKE MODIFICATIONS TO FLOORPLANS, MATERIALS, AND SPECIFICATIONS WITHOUT NOTICE. ILLUSTRATIONS ARE ARTIST RENDERINGS AND DO NOT REFLECT STANDARD FINISHES. ORAL REPRESENTATIONS CANNOT BE RELIED UPON. DESIGNED BY SOUTHLAND DESIGNS. ALL RIGHTS RESERVED.