

The Addison

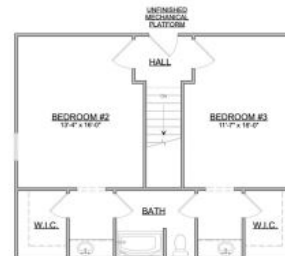

Carriage Series | 2 Car Rear Entry Garage | 3 Bedroom | 2.5 Bathrooms



First Floor:	1,633 sqft
Second Floor:	679 sqft
Garage:	464 sqft
Total Living Area:	2,312 sqft

SMITHBILT HOMES RESERVES THE RIGHT TO MAKE MODIFICATIONS TO FLOORPLANS, MATERIALS, AND SPECIFICATIONS WITHOUT NOTICE. ILLUSTRATIONS ARE ARTIST RENDERINGS AND DO NOT REFLECT STANDARD FINISHES. ORAL REPRESENTATIONS CANNOT BE RELIED UPON. DESIGNED BY SOUTHLAND DESIGNS. ALL RIGHTS RESERVED.